

Severe Weather Louver

IL80

8" Deep • Fixed Chevron Blade • Extruded Aluminum Stationary Louver

STANDARD CONSTRUCTION

- HEAD:** .125" thick; formed 6063-T5 aluminum
- SILL:** .125" thick; formed 6063-T5 aluminum
- JAMBS:** .080" thick; extruded 6063-T5 aluminum
- BLADES:** .24" thick at edges, reducing to .063" thickness at midpoint of profile

- BLADE SPACING:** 1.25"
- ASSEMBLY:** Welded and mechanical fastened
- FINISH:** Mill
- SCREEN:** None
- MULLIONS:** Exposed, vertical with 1.75" x .08" 6063-T5 extruded aluminum cover (multiple panels only); Exposed, horizontal

OPTIONS

- Finishes - Baked Enamel, Kynar, Anodize
- Variety of bird and insect screens
- Extended Sill (Formed .063" aluminum)

NOTES

1. "A" width and "B" height are opening dimensions. Louvers are provided approximately 1/2" undersize.

LOUVER SIZE

Panels	Min Panel	Max Single Panel
IL80	12"W x 18"H	48"W x 96"H

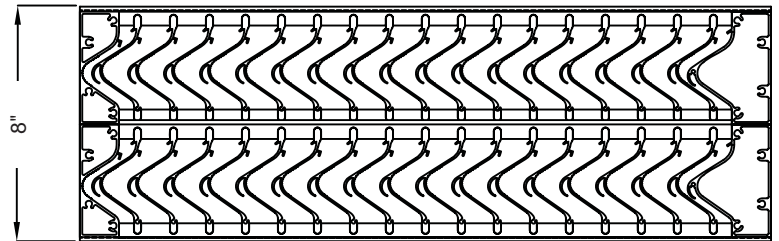
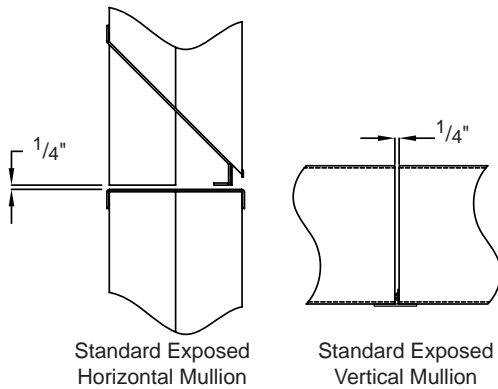
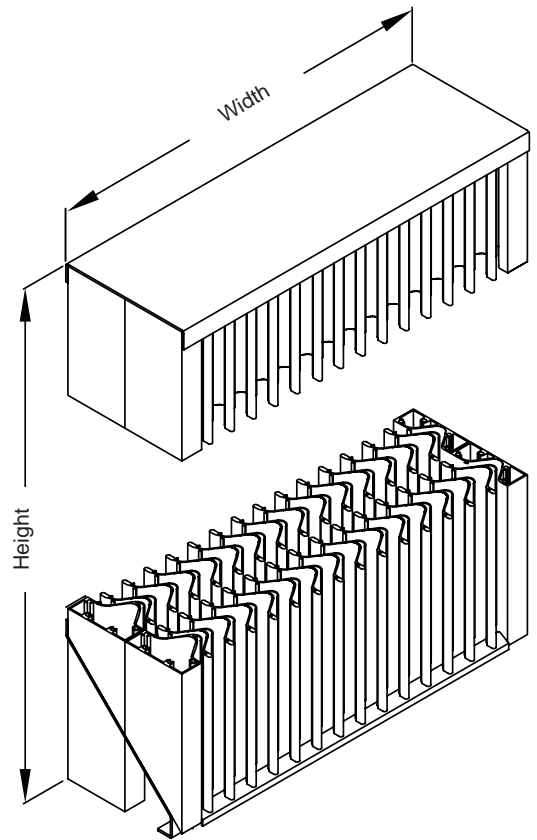

Section View

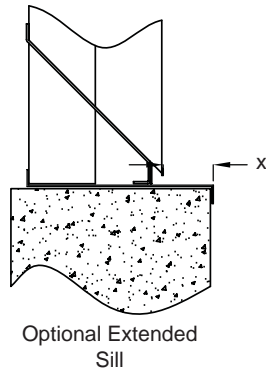

8" Deep • Fixed Chevron Blade • Extruded Aluminum Stationary Louver

Air Performance: 0.65 in.wg (161.91 Pa) at 1250 fmp (6.4m/s) and 9667 scfm (4.6 scm/s)

Free Area: 4.41 sq ft (0.410sq m) = 27.56%

1. Test size is 48"W x 48"H (1.2 m x 1.2 m).
2. Ratings do not include the effect of a screen.
3. Data is at standard air density.

Air Performance - Intake

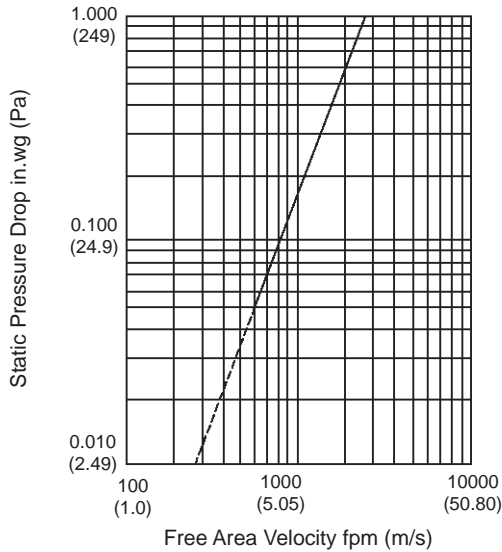

Sand Removal Efficiency

Pressure Drop	.10 in.wg (24.91 Pa)	.20 in.wg (49.82 Pa)	.30 in.wg (74.73 Pa)
Free Area Velocity	940 fpm (4.78 m/s)	1300 fpm (6.6m/s)	1600 fpm (8.13 m/s)
Sand Particle Size	Removal Efficiency	Removal Efficiency	Removal Efficiency
1-1100 MICRON	96.1%	86.3%	74.3%
1100-1500 MOCRON	99.9%	99.8%	99.2%

Free Area in sq.ft.(sq.m)

		Width								
		12 (305)	24 (610)	36 (914)	48 (1219)	60 (1524)	72 (1829)	84 (2134)	96 (2438)	
Height	18 (457)	0.18 (0.016)	0.41 (0.038)	0.65 (0.060)	0.88 (0.081)	1.12 (0.104)	1.35 (0.125)	1.58 (0.146)	1.82 (0.169)	1 Section
	24 (610)	0.32 (0.030)	0.73 (0.068)	1.17 (0.109)	1.58 (0.147)	2.02 (0.188)	2.43 (0.226)	2.85 (0.265)	3.28 (0.305)	
	36 (914)	0.60 (0.056)	1.39 (0.129)	2.21 (0.206)	3.00 (0.278)	3.82 (0.355)	4.61 (0.428)	5.39 (0.501)	6.22 (0.578)	
	48 (1219)	0.89 (0.082)	2.04 (0.190)	3.26 (0.303)	4.41 (0.410)	5.63 (0.523)	6.78 (0.630)	7.93 (0.737)	9.15 (0.850)	
	60 (1524)	1.17 (0.109)	2.69 (0.250)	4.30 (0.400)	5.83 (0.541)	7.43 (0.690)	8.96 (0.832)	10.48 (0.973)	12.09 (1.123)	2 Sections High
	72 (1829)	1.46 (0.135)	3.35 (0.311)	5.35 (0.497)	7.24 (0.673)	9.24 (0.858)	10.63 (0.988)	12.52 (1.164)	14.42 (1.339)	
	84 (2134)	1.74 (0.162)	4.00 (0.372)	6.39 (0.594)	8.65 (0.804)	11.04 (1.026)	12.71 (1.181)	14.97 (1.391)	17.23 (1.601)	
	96 (2438)	2.03 (0.188)	4.66 (0.433)	7.43 (0.691)	10.07 (0.935)	12.84 (1.193)	14.78 (1.374)	17.42 (1.618)	20.05 (1.863)	
		1 Section				2 Sections Wide				