

# Formed Steel Louver

**SL80**

4" Deep • Inverted "V" Blade • Formed Steel Stationary Louver

**STANDARD CONSTRUCTION**

- FRAME:** 18-GA galvanized steel channel type
- BLADES:** 18-GA galvanized steel
- BLADE SPACING:** 3"
- ASSEMBLY:** Riveted and/or welded for maximum service
- FINISH:** Mill
- SCREEN:** ½" mesh 19-GA galvanized

**OPTIONS**

- Flange Frame
- Extended Sub-Sills (3" or 5")
- Sub-Frame
- Installation Angles
- Stainless Steel, Copper, Aluminum, Other Steel Gauges
- Finishes - Baked Enamel, Epoxies
- Variety of Bird and Insect Screens
- Blank-Off Panels

**NOTES**

1. "A" width and "B" height are opening dimensions. Louvers are provided approximately ½" undersize.
2. Approximate louver weight is 10 lbs./sq.ft.

**LOUVER SIZE**

Panels	Minimum Panel	Maximum Panel
SL80	12"W x 12"H	60"W x 96"H

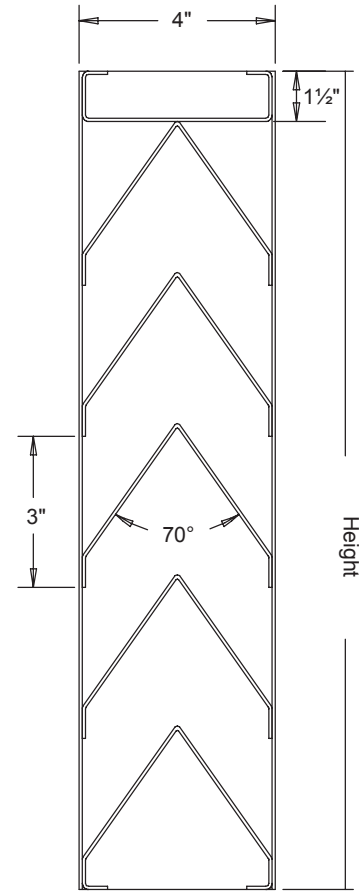

Section View

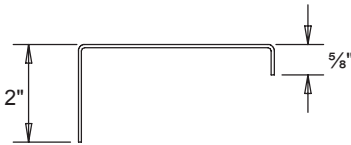

Optional Flange Frame

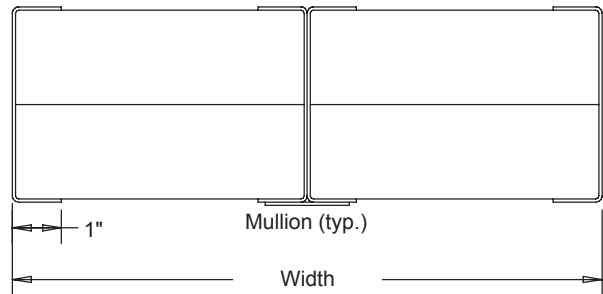

Top View

This page intentionally left blank.