

ROOF CURB ADAPTER / EXTENSION

S-CAE

Formed Steel

STANDARD CONSTRUCTION

- Fabricated of 18 gauge galvanized steel. All seams are fully welded and sprayed with protective coating.
- Mill finish is standard.
- If either dimension exceeds 90" multisection construction may be required.

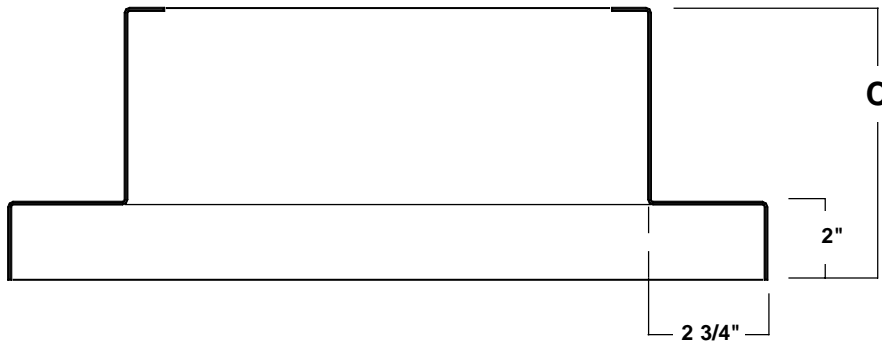
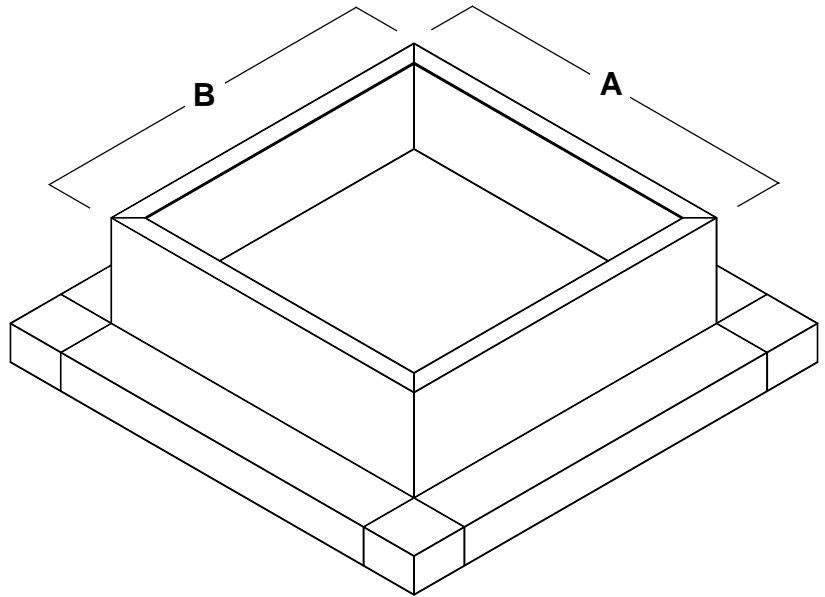

'A' (width)	'B' (width)	'C' (height)	Qty	Options / Accessories / Variations

PROJECT _____ LOCATION _____
 ARCH/ENGR _____ CONTRACTOR _____
 REPRESENTATIVE _____ DATE _____

PC00110 - April 2000

ROOF CURBS 

LD Louvers & Dampers

A DIVISION OF MESTEK, INC.

P.O. Box 606 • 7435 Industrial Rd • Florence, KY 41042 • Phone (859) 647-2299 • Fax (859) 647-7810

OPTIONS / ACCESSORIES

MATERIAL

Steel products are available in various gauges of Galvanized, Galvaneal or Stainless.

LINERS

A liner may be used for retention of insulation or as support to strengthen large units that will support a heavy load. Liners are manufactured as an integral part of the product to add maximum structural support.

CURB CAP

Standard curb cap of 2 3/4" can be replaced by 4 1/2" or other sizes by specifying.

PLATFORM CAP

A 3/4" plywood top with a metal cap fabricated of the same material as the product.

WOOD NAILER

Factory installed wood nailer for equipment mounting is mechanically fastened to top perimeter.

GASKET

1/4" thick polyurethane foam gasket can be installed, lining the entire top perimeter.

INSULATION

Available with either 1" or 2" Semi-Rigid insulation.

ACCESS PANELS

To provide a passageway to internal equipment, an access opening is cut and lined with a protective vinyl edge seal and the cover panel is mechanically fastened over the opening. Minimum height restrictions apply.

LOUVERED VENTS

To provide an airflow through the curb, units are available with 6" wide x 7/8" high louvered vents, with 4 per side. Minimum height restrictions apply.

DAMPER RACK

For mounting of dampers in the curb, a damper rack can be installed. The rack is located in the bottom of the curb and a damper is then mounted on top of the rack. Damper and/or rack flange dimensions must be specified.

SECURITY BARS

Selections of Bar diameters, Frame styles and Spacing are available.

FINISHES

A wide selection of finishes including Baked Enamel, Epoxy, or Prime Coat.