

BALANCING DAMPER

GB-1

Single Thickness Parallel Blades
200° Max. Temperature

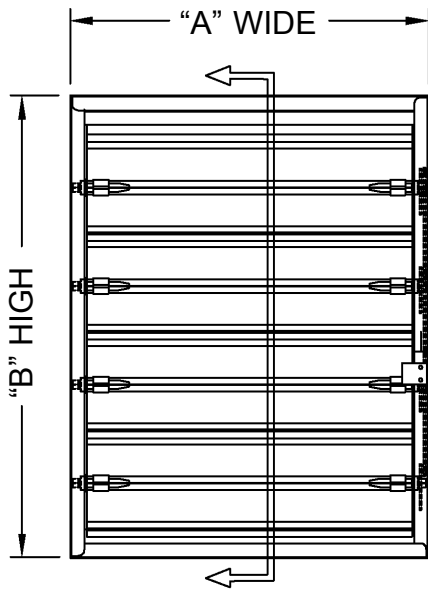

FACE VIEW

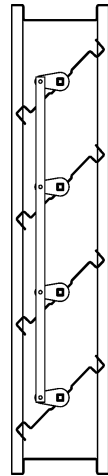

SECTION A-A

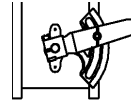

MANUAL QUADRANT AND
EXTENDED SHAFT
(SHIPPED LOOSE)

AVAILABLE OPTIONS

BEARINGS:
OIL IMPREGNATED BRONZE
STAINLESS STEEL

2" STANDOFF FOR MANUAL QUADRANT

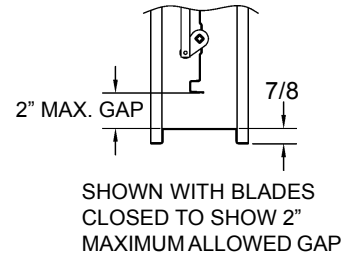

L&D Item No.	Quantity	"A" Wide Opening	"B" High Opening	Comments/Options

SPECIFICATIONS

- FRAME: 5-1/2" x 7/8" x 16-GA GALVANIZED STEEL HAT CHANNEL
- BLADES: PARALLEL 16-GA GALVANIZED STEEL, 6" NOMINAL WIDTH
- AXLES: PLATED STEEL STUB
- BEARINGS: NON-METALLIC NYLON
- LINKAGE: PLATED STEEL BAR AND CRANK PLATE WITH STAINLESS STEEL PIVOTS, IN-JAMB TYPE
- STOPS: NONE PROVIDED, UNLESS GAP EXCEEDS 2"; SEE DETAIL.
- FINISH: MILL.
- ACTUATOR: A 1/2" DIAMETER REMOVABLE EXTENDED SHAFT WITH INDIVIDUAL PANEL LOCKING MANUAL QUADRANT AND GASKET.

NOTES

1. MEETS SMACNA'S DUCT CONSTRUCTION STANDARDS FOR VOLUME DAMPERS.
2. MAXIMUM SINGLE SECTION SIZE: 48"W x 48"H
MINIMUM SINGLE SECTION SIZE: 6"W x 8"H.
3. DIMENSIONS: "A" (WIDTH) AND "B" (HEIGHT) DIMENSIONS ARE OPENING SIZES. DAMPERS WILL BE FABRICATED 1/4" UNDERSIZE.
4. MAXIMUM FACE VELOCITY: 2000 FPM
MAXIMUM DIFFERENTIAL PRESSURE: 4" W.G.
5. IF POSITIVE SHUT OFF IS REQUIRED, CONSIDER DAMPER MODEL GD-1 OR GD-2.
6. DAMPERS SHORTER THAN 12" ARE SINGLE BLADE.

CONTROL DAMPERS

LD Louvers & Dampers

A DIVISION OF MESTEK, INC.

P.O. Box 606 • 7435 Industrial Rd • Florence, KY 41042 • Phone (859) 647-2299 • Fax (859) 647-7810

BALANCING DAMPER

GB-2

Single Thickness Opposed Blades
200° Max. Temperature

AVAILABLE OPTIONS

BEARINGS:
OIL IMPREGNATED BRONZE
STAINLESS STEEL

2" STANDOFF FOR MANUAL QUADRANT

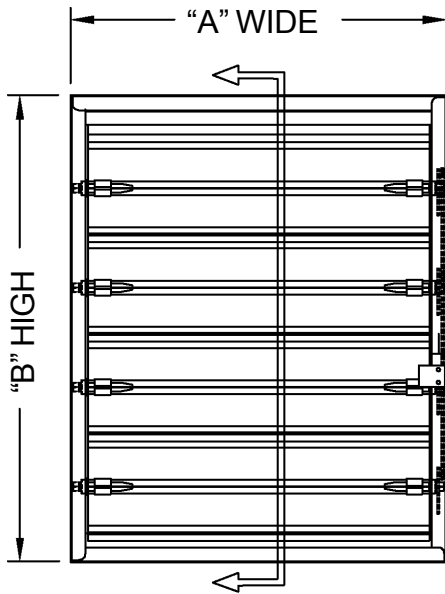

FACE VIEW

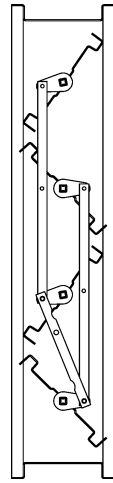

SECTION A-A

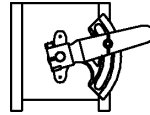

MANUAL QUADRANT AND
EXTENDED SHAFT
(SHIPPED LOOSE)

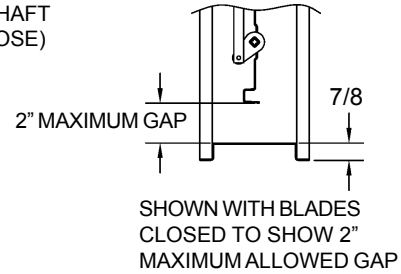

L&D Item No.	Quantity	"A" Wide Opening	"B" High Opening	Comments/Options

SPECIFICATIONS

- FRAME: 5-1/2" x 7/8" x 16-GA GALVANIZED STEEL HAT CHANNEL
- BLADES: OPPOSED 16-GA GALVANIZED STEEL, 6" NOMINAL WIDTH
- AXLES: PLATED STEEL STUB
- BEARINGS: NON-METALLIC NYLON
- LINKAGE: PLATED STEEL BAR AND CRANK PLATE WITH STAINLESS STEEL PIVOTS, IN-JAMB TYPE
- STOPS: NONE PROVIDED, UNLESS GAP EXCEEDS 2"; SEE DETAIL.
- FINISH: MILL.
- ACTUATOR: A 1/2" DIAMETER REMOVABLE EXTENDED SHAFT WITH INDIVIDUAL PANEL LOCKING MANUAL QUADRANT AND GASKET.

NOTES

1. MEETS SMACNA'S DUCT CONSTRUCTION STANDARDS FOR VOLUME DAMPERS.
2. MAXIMUM SINGLE SECTION SIZE: 48"W x 48"H
MINIMUM SINGLE SECTION SIZE: 6"W x 12"H.
3. DIMENSIONS: "A" (WIDTH) AND "B" (HEIGHT) DIMENSIONS ARE OPENING SIZES. DAMPERS WILL BE FABRICATED 1/4" UNDERSIZE.
4. MAXIMUM FACE VELOCITY: 2000 FPM
MAXIMUM DIFFERENTIAL PRESSURE: 4" W.G.
5. IF POSITIVE SHUT OFF IS REQUIRED, CONSIDER DAMPER MODEL GD-1 OR GD-2.

CONTROL DAMPERS

LD Louvers & Dampers

A DIVISION OF MESTEK, INC.

P.O. Box 606 • 7435 Industrial Rd • Florence, KY 41042 • Phone (859) 647-2299 • Fax (859) 647-7810